



HobbyMaster Energizer

Thank you for purchasing this HobbyMaster Energizer.

Your new Energizer incorporates the latest in electric fencing technology, ensuring powerful control.

If for any reason you are not happy with your purchase, please return the energizer to your dealer within 30 days of purchase and we will give you a full refund - Guaranteed.

Gallagher Animal Management Systems
Private Bag 3026, Hamilton, New Zealand.
www.gallagher.co.nz

TWO YEAR WARRANTY
from date of purchase



MODEL

ENERGIZER SERIAL NO

DATE PURCHASED DEALER

This Energizer is warranted against failure within two years of date of purchase.

Warranty does not cover damage due to:

- Incorrect input voltage
- Physical mishandling
- Water immersion
- Contamination by battery acid
- Lightning strike
- Damage to external wiring

The Manufacturer and Distributor accept no responsibility for the misuse of this Energizer. NOTE: This Energizer complies with the necessary safety standards. Gallagher Group Ltd and their agents accept no responsibility for any accident caused subsequent to any tampering with or modification to or misuse of this Energizer.

See "IMPORTANT SAFETY INFORMATION" section of enclosed Instructions.
READ INSTRUCTIONS BEFORE USE

Exchange Service Modules are available at your authorized dealer.

Gallagher - Manufacturers of electric fences since 1938.

KEEP THIS PAGE - IT'S YOUR PROOF OF WARRANTY.

Important safety information

- **WARNING:** Read all instructions.
- Electric fences should be installed and operated so that they cause no electrical hazard to persons, animals or their surroundings.
- Electric fence constructions which are likely to lead to the entanglement of animals or persons should be avoided.
- In areas of public access, use an electric fence warning sign (G6020) every 10m (33ft) to identify the electrified wire(s).
- Check your local ordinance for specific regulations.
- Crossing with overhead powerlines should be avoided wherever possible. If such a crossing cannot be avoided, it should be made underneath the powerline and as nearly as possible to right angles.
- If connecting leads and electric fence wires are installed near an overhead power line, the clearances should be not less than those shown below:

Minimum Clearances from Power Lines	
Power Line Voltage V	Clearance M
≤ 1 000	3
> 1 000 & ≤ 33 000	4
> 33 000	8

- If connecting leads and electric fence wires are installed near an overhead power line, their height above the ground should not exceed 2m.
- This height applies either side of the orthogonal projection of the outermost conductors of the power line on the ground surface, for a distance of:
 - 2m for power lines operating at a nominal voltage not exceeding 1 000 V;
 - 15m for power lines operating at a nominal voltage exceeding 1 000 V.
- Fence wiring should be installed well away from any telephone or telegraph line or radio aerial.
- An electric fence should not be supplied from two different energizers or from independent fence circuits of the same energizer.
- For any two different electric fences, each supplied from a different energizer independently timed, the distance between the wires of the two electric fences should be at least 2m. If this gap is to be closed, this should be effected by means of electrically non-conductive material or an isolated metal barrier.
- Do not electrify barbed or razor wire in an electric fence.
- **WARNING:** Risk of Electric Shock. Do not connect the Energizer to a fence and to any other device such as a cattle trainer or a poultry trainer. Otherwise, lightning striking your fence will be conducted to all other devices.

- Do not install an earth (ground) system for your Power Fence within 10m (33ft) of any utilities type ground system.
- Except for low output battery operated energizers, the energizer earth electrode should penetrate the ground to a depth of at least 1m.
- Use lead-out cable in buildings and where soil could corrode exposed galvanised wire. Do not use household electrical cable.
- Connecting leads that are run underground should be run in a conduit of insulating material or else insulated high voltage cable should be used. Care should be taken to avoid damage to the connecting leads due to the effects of animal hooves or tractor wheels sinking into the ground.
- Refer servicing to qualified Gallagher service personnel.
- Do not place combustible materials near the fence or Energizer connections. In times of extreme fire risk, disconnect Energizer.
- Train livestock to Power Fencing prior to entry into pastures. Allow livestock to approach a Power Fence for the first time without stress.
- Do not handle power cord if temperature is below +5°C.
- If the supply cord is damaged, it must be replaced by the manufacturer or its service agent or similarly qualified person in order to avoid a hazard.
- **Game Fencing:** Power Fencing has been used widely throughout the world for game animals, deer, bears, elk and elephant. Power Fences are a psychological barrier and should not be considered a complete physical barrier fence. With any Power Fence occasional animal penetration may occur (as with any other type of fence). It is important for game fencing to have power on the fence the same day as the fence is constructed. Animals investigating the new obstruction will be shocked and will relate the shock to the new obstruction. If no power is on the fence and animals learn to walk through the fencing system with no electric shock, this causes major problems later on since they will not relate the electric shock to the fence after the power is turned on. A Power Fence is not recommended for animals under hunting pressure. For specific questions on game fencing contact your Gallagher dealer.
- **Bird Deterrent:** Where the Energizer is used to supply a system of conductors used for deterring birds from roosting on buildings, no conductor should be connected to earth. A switch should be installed to provide means of isolating the Energizer from all poles of the supply and clear warning signs should be fitted at every point where persons may have ready access to the conductors. The notice should bear the words "LIVE WIRES" in block letters not less than 13mm (½" high). The letters should be red on a white background. Each notice should be at least 62mm x 50mm (2½" x 2").
- The appliance is not intended for use by young children or infirm persons without supervision.
- Young children should be supervised to ensure that they do not play with the appliance.

- Connecting leads shall not be installed in the same conduit as the mains supply wiring, communicating cables or data cables.
- Connecting leads shall not be installed in the same conduit as the mains supply of wiring, communicating cables or data cables.
- A non-electrified fence incorporating barbed wire or razor wire may be used to support one or more off-set electrified wires of an electric animal fence. The supporting devices for the electrified wires shall be constructed so as to ensure that these wires are positioned at a minimum distance of 150mm from the vertical plane of the non-electrified wires. The barbed wire and razor wire shall be earthed at regular intervals.
- Where an electric animal fence crosses a public pathway, a non-electrified gate shall be incorporated in the electric fence at that point or a crossing by means of stiles shall be provided. At any such crossing, the adjacent electrified wires shall carry warning signs (G602).

How HobbyMaster works

The HobbyMaster Energizer sends electrical pulses along the fence line, about one second apart. These pulses give the animal a short, sharp, but safe shock. The shock doesn't harm the animal. It is sufficiently memorable that the animal never forgets the shock, and will avoid the fence.

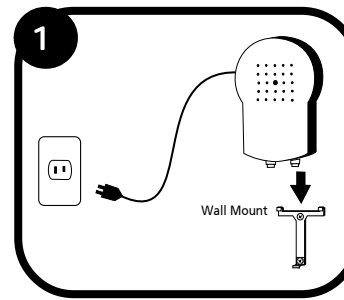

STEP-BY-STEP INSTALLATION INSTRUCTIONS

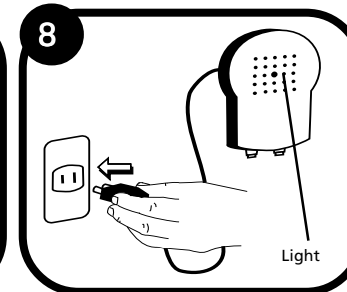
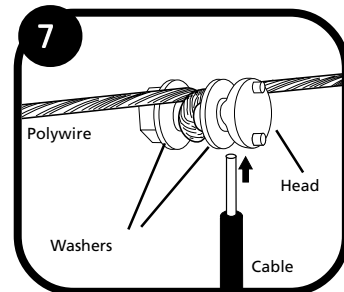
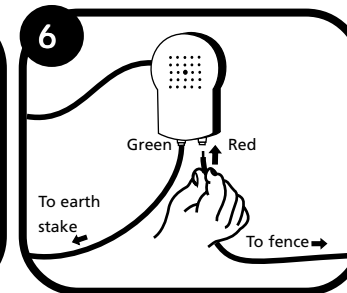
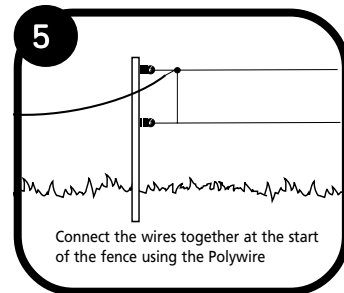
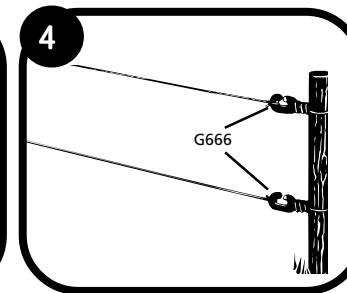
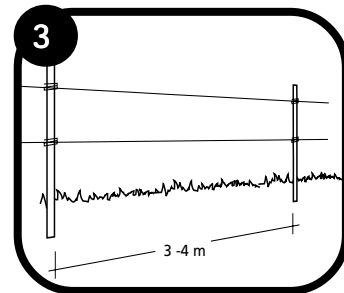
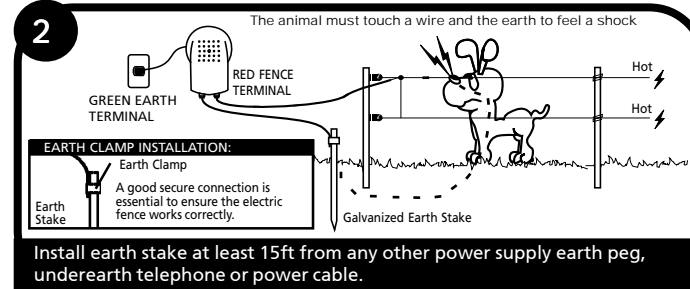

Step 1: Install the Hobby Master Energizer

Install under cover, out of reach of children, next to a mains power outlet. Using the 2 screws provided, screw the mounting bracket to the wall. Attach the Hobby Master to the bracket by hooking it over the 2 prongs and snapping the bottom into place. Do not switch the energizer on until the fence has been constructed. To remove, first disconnect from power supply and then use a slotted screwdriver to release the bottom clip and lift the HobbyMaster off the wall mount.

Step 2: Install the Earth Stake

Install a galvanized earth stake (at least 60cm long) into the ground, until only 5cm remain above the earth. The most effective place for an earth system is in continuously damp soil. Using double insulated cable (G609 or G627), remove 5 cm of plastic coating from one end of the cable wire. Press the green (EARTH) terminal button and insert the wire into the terminal. Secure the cable to the wall (e.g. with a staple) so the cable does not put any strain on the energizer terminal. Attach the other end of the cable to the earth stake using an earth clamp.

Step 3: Install Fibreglass Fence Stakes

Install fence stakes (at least 60cm long and at least 10cm into the ground). Attach clips to each post at the required height. The bottom wire should be low enough to ensure that the animal cannot crawl under the fence without touching the wire. The top wire should be positioned between chest and nose height of the animal.

Step 4: Install Insulators

Use Screw-in Ring insulators (G666) or Pinlock insulators (G687) to insulate the start and end points and the corners.

Step 5: Install the Polywire

Tie Polywire (G621) to the insulators at the start of the fence. Roll out the Polywire and tie to the insulators at the end of the fence. Hand tension the Polywire until it is taut (no sag), then attach to each clip on the fence.

Step 6: Connect Cable to the Fence Terminal

Connect the Energizer's red (FENCE) terminal to the fence using double insulated cable (G609 or G627). Remove 2" of plastic coating from one end of the cable. Press the RED (fence) terminal button and insert the wire into the terminal.

Step 7: Connect Cable to the Fence

Attach the other end of the cable to the fence. To ensure a good connection, wrap one loop of the Polywire between the washers of the Joint Clamp (G603), and insert the cable between the head and closest washer.

Step 8: Connect to Mains Power Supply and Switch On

Check that the light on the front of the HobbyMaster is flashing.

Testing the Fence

- Check the fence periodically using a Digital Volt Meter (G503).
- If you don't have a fence tester, use a blade of grass. To do this hold the grass between your thumb and forefinger and touch the grass to the fence wire. Slowly move closer until a pulse is felt.
- Always be on the lookout for fallen branches, weeds or shrubs on the fence. Remove them from the fence because these will cause the fence to short out and be less effective.

Joining Fences

If you want to join 2 fences or to run the fence under an object, use double insulated cable (G609 or G627) and Joint Clamps (G603).

If there is no Pulse on the Fence

1. Check whether the HobbyMaster is working: if the light is not flashing, test the mains power supply. If the power supply is OK, the HobbyMaster needs to be serviced.
2. Check the cable to the earth stake and the cable to the fence is not broken.
3. Check the connections at the earth stake and at the fence are secure.
4. Remove fallen branches, weeds or shrubs from the fence.

Additional Accessories:

Warning sign (G602):

Alerts people to your new HobbyMaster fence.

Neon Fence Tester (G501):

See at a glance if your fence is switched on.

Digital Volt Meter (G503):

See exactly how your HobbyMaster fence is performing.

Need to extend your HobbyMaster fence?:

See your Gallagher dealer, they'll be happy to help.

Save these Instructions